

# WINDERMERE

1197 Waterford Drive • Waterford, Chestermere



1490 sq ft



3 bedrooms



2.5 bathrooms



20'



## FEATURES

- ✓ Basement Side Entry
- ✓ Rear Parking Pad
- ✓ Main Floor Flex Room
- ✓ 9' Main Floor Ceiling
- ✓ Quartz Countertops
- ✓ Electric Fireplace
- ✓ Eng. Hardwood Main Floors
- ✓ Upper Floor Laundry
- ✓ Double Sinks to Ensuite
- ✓ Hooks at Rear

LINE OF FLOOR ABOVE

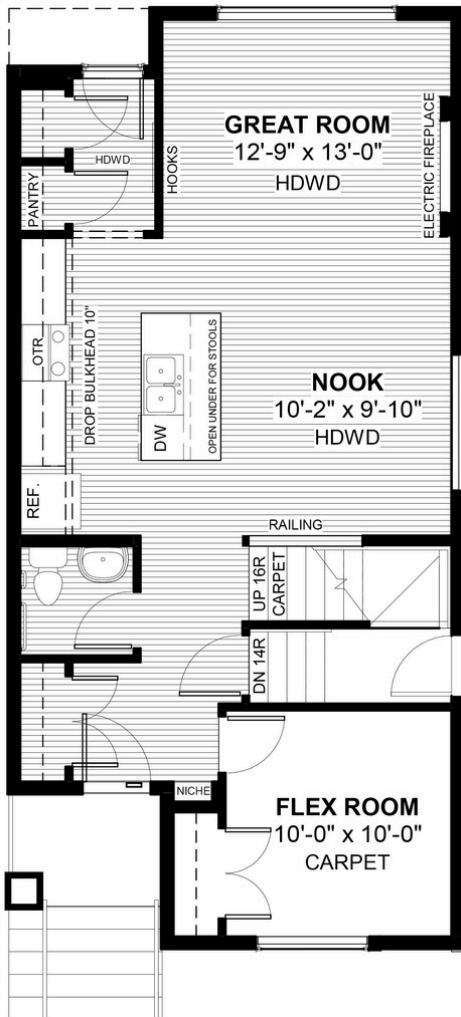

## NOTES



\*Price includes lot&gst. Price, features & plan are subject to change at any time. All plans/designs are the exclusive property of Douglas Homes Ltd.